

# The AUTOLITH<sup>®</sup> URO-TOUCH System

## Quick Reference and Information Guide

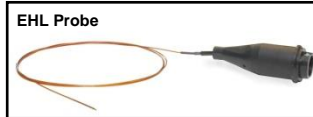

1

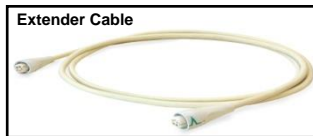

2

(1) After connecting the power cord to rear of unit and to a properly grounded power source, turn on main power switch at rear of unit. Activate power to the unit by touching the front of the LCD screen.

(2) Attach the pneumatic foot-pedal connector to the port located on the lower left side of the front panel.

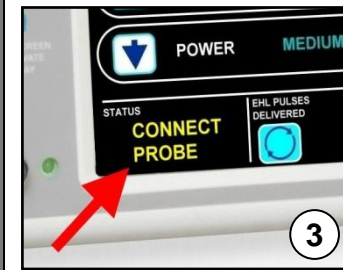

3



4

(3) Prepare to connect the EHL probe.

(4) Attach one of the extender cable ends to the connector located at the lower right side of the front panel. Align the green lines to connect the cable to the front of the unit.



5



6

(5) Connect the remaining end of the extender cable to the connector portion of the EHL probe. Align the green lines to connect.

(6) Once the EHL probe is connected properly, the "READY" indicator will become visible.



7



8

(7) Select the number of desired EHL pulses. One pulse per foot-pedal depression is recommended when starting the procedure. 3-5 pulses is ideal for most procedures.

(8) Select the power level. Always start LOW and increase the power as needed. The power levels are LOW, MEDIUM and HIGH.



9



10

(9) Feed the EHL probe into the endoscopic environment.

(10) Depress the ACTIVE MODE / START icon to allow delivery of the EHL pulses. The distal tip of the EHL probe should be placed perpendicular to the stone surface. Ideally, the tip of the probe should be placed 1-2mm from the stone surface. ALWAYS use .9% normal saline to irrigate the operative environment.



11

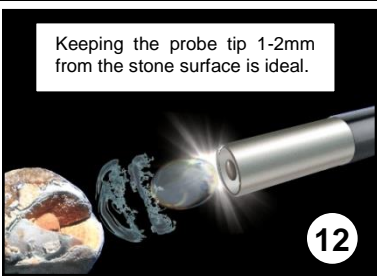

12

(11) Once the number of pulses and the power level have been selected, the user can begin the EHL treatment by stepping on the foot-pedal. Step off and re-depress the foot-pedal to deliver another round of EHL pulses.

(12) The EHL treatment is always performed under direct endoscopic visualization.



13



14

(13) Depress the STANDBY / PAUSE icon when the EHL treatment is not required. This will prevent an unintentional discharge of EHL pulses if the foot-pedal is accidentally depressed.

(14) The total number of EHL pulses delivered can be reset at any time by depressing the RESET VALUE icon.



15

(15) The user can access the set-up menu at any time by depressing the SET-UP MENU icon located in the upper right corner of the screen. Changes to Program Defaults including Pulses and Power can be made. Also, Language setting adjustments and Product Service Information is available.

Note: A complete explanation of all the product features are detailed in the operator's manual. Please be sure to read and understand the operator's manual thoroughly before using the AUTOLITH® URO-TOUCH system.

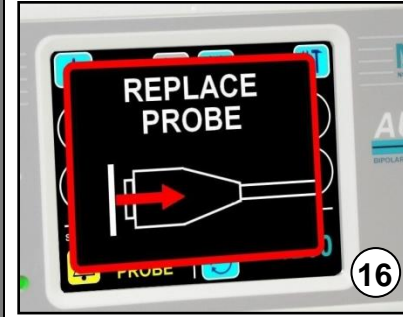

16



17

(16) EHL Probe life is dependent on the number of pulses delivered and the power level selected. A series of alerts and a final warning will be displayed on the screen indicating when a new probe will be required.

(17) When finished using the AUTOLITH® URO-TOUCH product, depress the POWER DOWN icon located at the upper left side of the screen. To restart the unit, see step #1.

**! CAUTION !** This Quick Reference Guide is not a replacement or substitute for the AUTOLITH® URO-TOUCH unit operator's manual. Please be sure to read and understand the AUTOLITH® URO-TOUCH system operator's manual thoroughly before using the product.

- 9-203-00 .....AUTOLITH® URO-TOUCH SYSTEM\*, 100-230VAC, 50/60Hz. (For Urologic Stones)
- \*AUTOLITH® URO-TOUCH system includes: Extender Cable, Pneumatic Foot-Switch, Power Cord and Operator's Manual (Disposable EHL probes are sold separately)

**Disposable BiPolar EHL Probes for use on the AUTOLITH® URO-TOUCH Generators**

- 9-203-1203.....1.9fr. (.63mm) Ureteral Probe (120cm) (Sterile) 3/Box
- 9-203-0543.....9.0fr. (3.0mm) Urinary Bladder Probe (54cm) (Sterile) 3/Box

**AUTOLITH® URO-TOUCH System Accessories**

- 9-001-00 ..... Pneumatic Foot Switch
- 9-003-00..... Hospital Grade Power Cord for U.S.A.
- 9-004-00..... Extender Connection Cable



™/® trademarks and registered trademarks of or used under license by NORTHGATE Technologies Inc.