

# Flo-Assist® II

## PRESSURE AND FLOW ENHANCED IRRIGATION



**NORTECH**®  
NORTHGATE TECHNOLOGIES INC.

- **No Expensive Equipment**

Completely disposable high flow tubing set includes all necessary components/connectors in a simple, all-in-one design

- **Hand or Foot-Assisted Fluid Management Chamber**

Surcharge of fluid automatically pre-loads and can be delivered as needed to control irrigation pressure and flow

- **Modular Design Allows for Multi-Purpose Use**

Can be used with two-spike or four-spike systems and can be configured for post-operative irrigation through a Foley catheter (adapter included)

- **Approved for Urologic and Arthroscopic procedures**

### Introducing the Next Generation of Gravity Fluid-Flow Irrigation Products

Flo-Assist® devices give physicians the power to take control of irrigation pressures during endoscopic procedures utilizing gravity fluid-flow. This completely disposable tubing set provides a low-cost method of improving arthroscopic and urologic procedural technique. An easy-to-use foot pedal gives the physician immediate control over the timing and increase of irrigation pressures during the procedure. Flo-Assist® allows the physician to deliver bolus fluid-flow when required, helping to:

- **Dilate the operating area** to allow for additional working space (or easier scope insertion during urologic procedures)
- **Remove debris** to improve visualization of the operating field
- **Compensate for declining pressure** from gravity-fed irrigation as the fluid bag empties

# The Flo-Assist<sup>®</sup> II

## Quick Reference and Information Guide



™ / ® trademarks and registered trademarks of or used under license by NORTHGATE Technologies Inc.

### Ordering Information

- **Flo-Assist<sup>®</sup> II**  
Combination foot-pedal or hand squeeze  
Disposable (Sterile) 10 per box.  
Order # 7-510-49

### 1 Getting Started

Peel open the package and place the sterile, single use **Flo-Assist<sup>®</sup> II** tubing set in the sterile field. Keep the distal tubing portion containing the roller clamp section in the sterile field. Pass the proximal portion and the foot pedal to the person circulating outside of the sterile field. Close off the ratchet clamp at the proximal end of the tubing set.

### 2 The Foot-Pedal

Place the foot pedal on the floor. Flip the pedal portion into the “up” position as shown. Proceed to spike the irrigating fluid bag hanging from an IV pole.

**Always ensure that all male/female luer connections are tightened before use.**

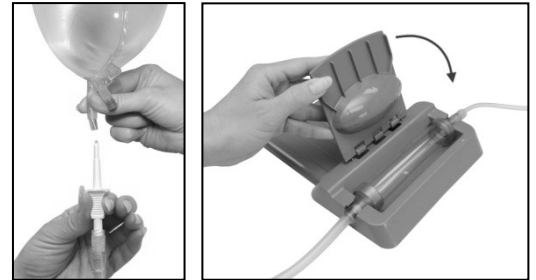

### 3 Prime the Tubing

Open the ratchet clamp at the proximal end of the tubing set and allow fluid to flow using gravity. Adjust the amount of flow using the roller clamp. Step on the foot pedal 4-5 times to prime the fluid management chamber. Close the roller clamp when fully primed and attach the male luer fitting to the endoscope fluid channel connection.

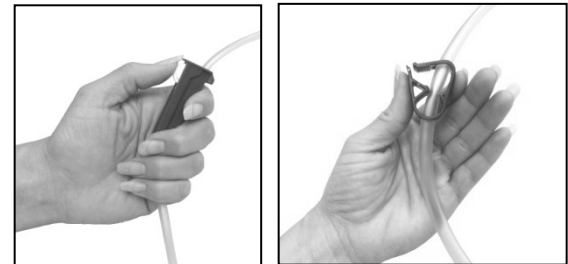

### 4 Fluid Delivery

When delivery of fluid irrigant is required, open the roller clamp and allow high flow gravity fed irrigant to reach the operative site. Step on the **Flo-Assist<sup>®</sup> II** foot pedal when a bolus of additional volume of fluid irrigant is required. This is ideal when trying to get fluid to flow through restrictive channels similar to those in small flexible endoscopes. **DO NOT** attempt to use the pump device and foot pedal during post operative irrigation.

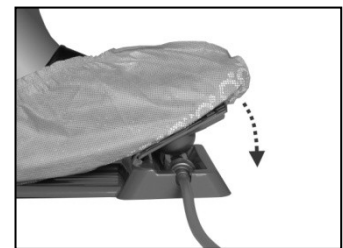

### 5



- If **HAND ACTIVATED USAGE** is preferred, remove the fluid management chamber from the disposable foot pedal and discard the foot pedal. Squeeze the pump device by hand to deliver an added bolus flow of fluid when needed.
- **POST OPERATIVE IRRIGATION** through a Foley catheter is possible using the supplied adapter fitting. The proximal portion of the tubing set is ideal for this purpose.
- For **USE WITH EXISTING CYSTO TUBING SET**, untwist the male luer fitting and connect existing **CYSTO** tubing connector to the remaining female luer fitting. Discard the proximal portion of the tubing set.

Note: This Quick Reference guide is not a substitute for the “instructions for use” packaged with the product.